



  
**vahaa**  
SMART GARDEN  
MANUAL

# THANK YOU!

Sending a virtual high-five and a big thank you for supporting our mission of a sustainable future.

You're making a difference!

QUESTIONS? COMMENTS? CONCERNS?

Please reach us anytime at [support@vahaa.co](mailto:support@vahaa.co)

# Important Warnings



- Please check whether the voltage value specified in the Technical Specifications section of this user manual prepared for your Vahaa Smart Garden is compatible with the voltage value in your region. Voltage differences can cause the Vahaa Smart Garden to malfunction.
- The Vahaa Smart Garden is designed for household use only. Please do not use it for commercial or industrial purposes.
- Use only the adapter that comes with your Vahaa Smart Garden. The use of an inappropriate adapter can cause serious damage to your Vahaa Smart Garden.
- When the Vahaa Smart Garden is positioned in unsuitable environments, it may attract insects. (see article 6:Where should it be positioned?)
- This device can be used by children aged 8 and over, as well as by individuals with physical, sensory or mental impairments, or with insufficient experience or knowledge, provided that they are supervised or given instructions on how to use the device safely and understand the risks involved. Children should not play with the device. Cleaning and user maintenance should not be performed by children unsupervised.
- Do not use your Vahaa Smart Garden near bathtubs, shower enclosures or other containers that contain water.
- Never look directly at the LED lights from close range and/or for extended periods. Doing so may cause partial or permanent loss of vision.
- Please do not use extension cords that do not provide sufficient current to prevent damage to your Vahaa Smart Garden.
- Never immerse your Vahaa Smart Garden in water or any other liquid, do not wash it under a hose or running water, and do not use it near containers filled with water or any other liquid. You can clean the outer surface of your device with a dry or damp cloth when not in use.

# Important Warnings



- Do not touch Vahaa Smart Garden if it falls into water or any other liquid. Immediately unplug it and contact the Vahaa team ([support@vahaa.co](mailto:support@vahaa.co)).
- If the cable or plug of your Vahaa Smart Garden is faulty or damaged due to dropping or any other reason, do not use the product. Do not try to open or repair it yourself, contact the Vahaa team ([support@vahaa.co](mailto:support@vahaa.co)).
- Please avoid any actions that may damage the cable and plug of your Vahaa Smart Garden.
- Do not carry it by the cable. Never try to pull the plug by the cable. Do not wrap the cable around the device under any circumstances.
- Use only original spare parts and accessories for your Vahaa Smart Garden. Using a non-original spare part may cause permanent damage to your Vahaa Smart Garden.
- Do not attach accessories from other products to your Vahaa Smart Garden.
- Since Vahaa Smart Garden is made of plastic (ABS) and aluminum components, avoid direct contact with your mouth.
- As the Water Reservoir of Vahaa Smart Garden is filled with approximately 4.5 liters of water, be careful not to place it in an area where it can easily fall.
- Keep the cable of the power adapter away from hot surfaces.
- Plug your Vahaa Smart Garden only into grounded outlets. Always make sure that the plug of the power adapter is properly inserted into the outlet.
- Vahaa Smart Garden must be used in accordance with the user manual. Improper use may cause injury or damage to the device. If Vahaa Smart Garden is used in ways that do not comply with the instructions, the warranty will be void and Vahaa may reject any responsibility regarding such damages.

# TECH SPECS

## OVERVIEW

Product Name	Vahaa Smart Garden
Model Name	VSG001
Seed Pod Capacity	6 Pods
Material	Plastic (ABS) and Aluminium

---

## DIMENSIONS

Length	41 cm
Depth	15 cm
Height	18 cm
Weight	2.1 kg (without water)
Adjustable Led Arm	

---

## WATER TANK

Pump	Submersible mini water pump with water shortage protection
Pump Power	0.5 W
Pump Voltage	12V DC
Water Tank Capacity	4.5 Lt

---

## LED LIGHT:

Consumption	9.4 kWh/month (depending on the light mode)
LED Light Modes	<ul style="list-style-type: none"><li>Germination Mode</li><li>Grow Mode</li><li>Flowering / Fruiting Mode</li></ul>

---

## APP

Connectivity	Wi-fi (2.4GHz)
Supported operating systems	IOS and Android

---

## SENSORS & INDICATORS:

Temperature Sensor  
Humidity Sensor  
Water Level Indicator  
Notification Indicators

---





## TABLE OF CONTENTS

- 1- Components
- 2- How to Set Up?
- 3- How to Plant?
- 4- How to Grow?
- 5- How to Connect to Vahaa App?
- 6- Am I Ready?
- 7- Where to Locate?
- 8- How to Clean?
- 9- Troubleshooting

# 1- Components

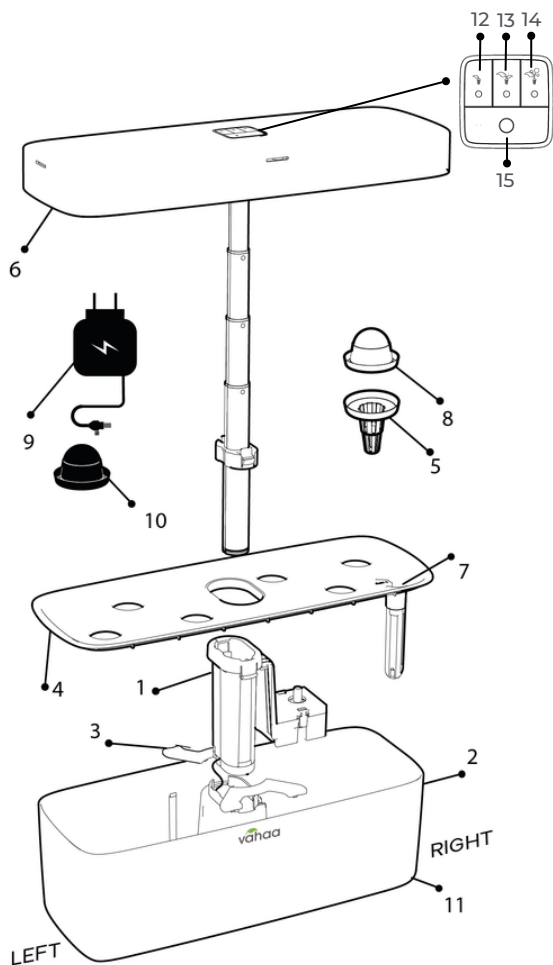

1- Pump Module

2- Water Tank

3- Water Tank Supports (x2)

4- Seedpod Tray

5- Seedpod Baskets (x6)

6- Light Module

7 - Water Level Indicator

8- Germination Domes (x6)

9- Power Adapter

10- Black Domes (x4)

11- Drain Plug

12 -Germination Light Button

13- Grow Light Button

14- Flowering/Fruiting Light Button

15- Power Button

# 1- Components

## Component Descriptions

### **Pump Module**

Water pump module is used to aerate the water in the water tank continuously. It runs for 15 minutes every hour and stays off for 45 minutes.

### **Water Tank**

The main part in which the water (approx.4,5 lt) and pump module locate. By the virtue of seedpots in the baskets reach to the water in the tank.

### **Water Tank Support**

As you fill the tank with water, due to expansion tendency of the plastic material of the tank, water leaks may occur during the pump is working. In order to keep the tank in a stable form, the relevant support components should be properly installed in place.

### **Seedpod Tray**

The tray mechanism is a system that facilitates the growth and exposure of plants to the water through seedpods placed on the trays.

### **Seedpod Baskets**

Seedling baskets are the parts that hold seedpods and enable plants to stand in an upright position, They facilitates the unrestricted movement of their roots to access water.

### **Water Level Indicator**

Water level indicator goes up once you add the water and goes down once the water level decreases. You need to check the water level indicator frequently and add water and nutrient according to the instructions. Water level indicator should be at the same level with the MAX marking on the tray when the tank is full.

### **Germination Domes**

Germination domes are used to create a greenhouse effect to enable the seeds germinate faster. Domes should be removed once the plants touch to them.

### **Power Adapter**

The device that provides electrical power to Vahaa Smart Garden. It typically consists of two main parts, the AC adapter and the DC connector. The AC adapter plugs into the power outlet, while the DC connector connects to the device, delivering the converted direct DC power.



## **Black Domes**

Vahaa Smart Garden has six plant holders for planting at a time. If for some reason any of the plant holders remain unplanted, those ones should be closed with plant holder lids in order to prevent plant roots from dust, harmful substances or light.

## **Drain Plug**

During the cleaning, you can easily drain the water inside the water tank by turning the water drain plug by turning it counter clockwise. Be sure that the black gasket is still in its place between the water tank and water drain plug once you drain the water.

## **Light Module**

LED Module is designed to give optimum light to maximize the rate of photosynthesis. It runs for 16 hours a day and stays off for 8 hours a day. It has 3 different light modes:

### **Germination Light Button**

LED Module is designed to give optimum light to maximize the rate of photosynthesis. It runs for 16 hours a day and stays off for 8 hours a day. It has 3 different light modes:

### **Grow Light Button**

This button activates growing mode, and is set on till the leafy greens and herbs are ready for harvest.

### **Flowering/Fruiting Light Button**

This button activates flowering/fruiting mode, and is set on once the first flowers appear for the plants with flowers like mini tomato, pepper, edible flowers, etc.

## **Power Button**

This button is used to turn Vahaa Smart Garden on or off. When you see a red light on power button when the adapter is plugged in, it means that Vahaa Smart Garden is off. If the light is green, then it means Vahaa Smart Garden is working properly.

## 2- How to Set Up?

Please take all components out of the water tank before starting to set up. Take the plant holder, germination domes, plant holder lids and power adapter inside the water tank by lifting the tray up.

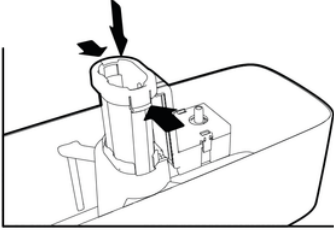

### STEP 1

Place the pump module (1) inside the water tank (2) and feed the cable through the hole.

### STEP 2

Be sure to push the cable into the narrow groove under the water tank.



### STEP 3

Insert the two water tank supports (3) between the water tank (2) and pump module (1), thereby ensuring that they click into place.

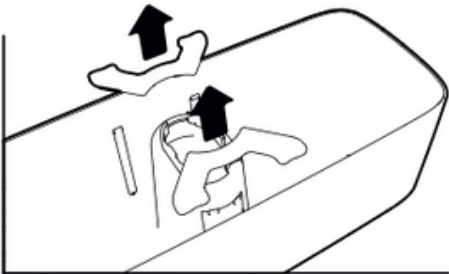

## 2- How to Set Up?

### STEP 4

Place the seedpod tray (4) on top of the water tank. Make sure that the seedpod tray is placed correctly. The water level indicator and the drain plug should be on the same direction.

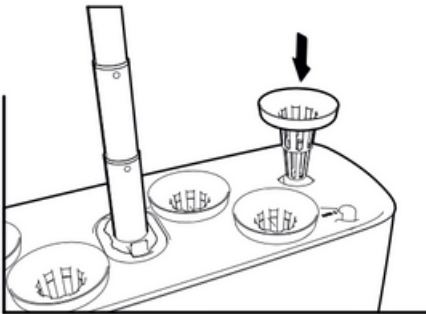
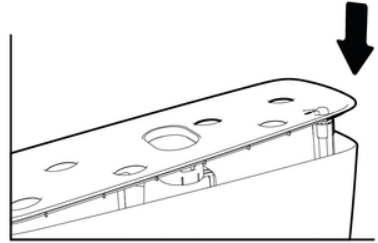

### STEP 5

Insert the six seedpod baskets (5) into the empty spaces on tray.

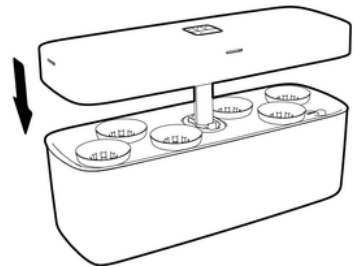

### STEP 6

Place the light module (6) in its designated spot by extending it two sections (~10 cm).

**NOW YOU ARE READY TO PLANT!**

### 3- How to Plant?

#### STEP 1

Pour water into the water tank until the water level indicator (7) shows that you have reached to the top.

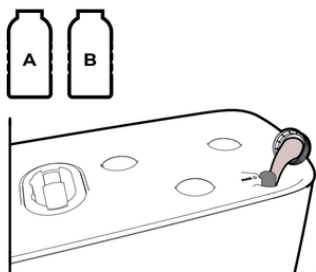
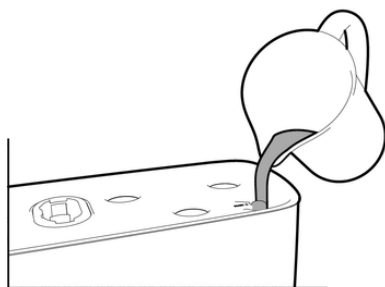

#### STEP 2

Add 2 caps of each nutrient to the water tank separately. Do not mix the nutrients before adding them to the water tank.

#### STEP 3

- Remove the first sticker with the plant name. This will remove the small sponge attached to it but if not, remove it manually. Make sure that the seeds do not fall out and do not stick to the sponge.
- Keep only the plain white sticker and ensure there are no other materials inside besides the seeds.
- Repeat this step for all seedpods.



### 3- How to Plant?

#### STEP 4

Insert the seedpods into the seedpod basket (5) and push them down until they reach the bottom.

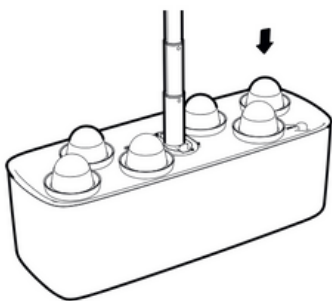
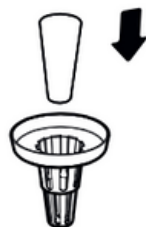

#### STEP 5

Place the germination domes (8) onto the seedpods to create a greenhouse effect and maintain humidity.

#### STEP 6

Attach the power adapter (9) to the cable of the pump module (1) which comes from under the water tank and then plug it into a power outlet. Finally, press the power button (15).

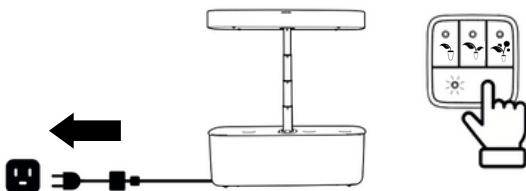

## 4- How to Grow?

Adjust the extendable arm of the light module to be approximately 10 cm away from the plants, which is about the same height as a pencil and ensure that the light colour is set to purple. If it is not, press the germination light button (12).

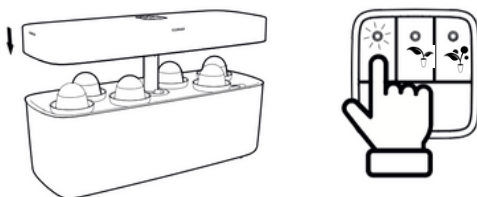

## GENERAL GROWING TIPS

Please note that each seed has its own cycle. For further information please download Vahaa App and scan the QR code inside Vahaa Seedpod Kit.

### LIGHT

- Vahaa Smart Garden has a default 16-8 days/night light schedule for plant growth. We recommend you start your light schedule at the beginning of the day. You may use our mobile app to schedule your day/night period for comfortable nights.
- Once your plants have sprouted, remove the germination domes (8) and press the 'grow light button' (13). Your harvest will be ready in a few weeks.
  - If you are growing fruits, veggies or flowers, press the 'grow light button' (13) initially and wait for blossoms to appear. Once you see the blossoms, press the 'flowering/fruiting light button' (14) for optimal growth.
  - Make sure to extend the light as your plant grows to avoid them getting too close to the light source. (Approx. 10 cm)

## 4- How to Grow?

### WATER & NUTRIENTS

- Every 2 weeks: Refill your water tank. Then, add 4 caps of each nutrient to the water tank separately.
- To check if the water level is low, simply look at the water level indicator (7) and see if the water has receded to the bottom.

### ACCESSORIES

- The black domes (10) can be used to cover any unused seedpod holes on the tray. They prevent light from entering the water.
- Keep all the germination domes, black domes and seedpod baskets for reuse.
- Vahaa has its own pre-seeded seedpod kits which are validated scientifically and also an experimental kit that has no seeds. You can get one of the validated Vahaa Seed Pod Kits or experimental kits to use your own seed and try different varieties.

### HARVESTING

Pruning/harvesting can begin as soon as the plants are big enough. See Vahaa Seedpod Kit Manual or Vahaa App for more information.

## 5- How to Connect to Vahaa App?

With the help of Vahaa App, you will be assisted to grow your healthy plants from seed to harvest. After scanning the QR code inside the Vahaa Seedpod Kit, Vahaa App will guide you through plant growth and send notifications about maintenance.

### 5.1- DOWNLOAD THE VAHAA APP



You can download the Vahaa App by visiting the App Store, Google Play Store. You can also reach the download links on Vahaa website. ([vahaa.co/mobile-apps](http://vahaa.co/mobile-apps))

### 5.2- FOLLOW IN-APP INSTRUCTIONS

You can create your account, connect to your Smart Garden and pair the Vahaa Seedpod Kit with your Smart Garden by following in-app instructions.

### 5.3- CONNECTION PROBLEMS

In case you cannot connect to your Smart Garden;

1. Make sure your Bluetooth settings are turned on.
2. Make sure your modem is 2.4GHz frequency compatible.
3. Your modem password must comply with the WPA2 encryption protocol.
  - a. Password must be at least 8 characters long.
  - b. Password must contain at least 1 uppercase and lowercase letters, numbers and special characters.
4. Your modem name should not contain spaces.
5. Check your internet connection.



## 5.4- RESETTING VAHAA SMART GARDEN

If the connection problem occurs although you follow the instructions, you need to reset your Smart Garden.

1. Press and hold all the light mode buttons (12,13,14) and Power button (15) on your Smart Garden at the same time. Within 10 seconds, the warning lights on the buttons will start to flash white.
2. Remove your previously paired Smart Garden from your phone's Bluetooth settings.

## 6- Am I Ready?

- ☐ Make sure that water level is enough.
- ☐ Make sure that two caps of Nutrient A and Nutrient B are added.
- ☐ Make sure to extend the light as your plant grow to avoid them getting too close to the light module. (Approx. 10 cm.)
- ☐ Vahaa Smart Garden should not be under direct sunlight.
- ☐ Do not remove the germination domes until your plants have sprouted.
- ☐ You should close the seedpod baskets with black domes (10) if there are any empty seedpod baskets.
- ☐ Use your device only with its original power adapter.

**YOU ARE DONE!**  
**SIT BACK AND WAIT FOR THE MAGIC!**

# 7- Where to Locate?

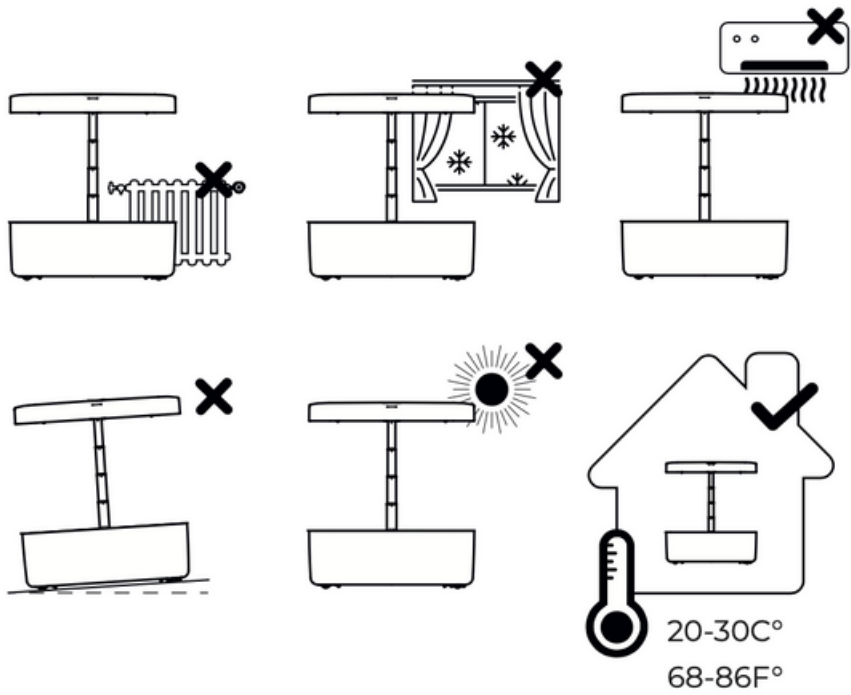

## 8- How to Clean?

Unplug the power adapter before filling or draining the water tank. Clean the water tank after you harvest all your plants.

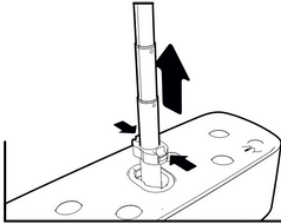

### STEP 1

Remove the light module by pressing on the latches and pulling at the same time.

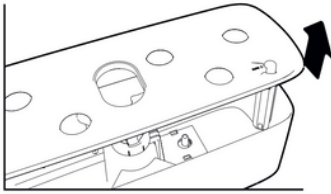

### STEP 2

Remove the seedpod tray.

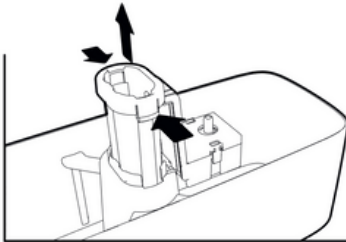

### STEP 3

Remove the pump module by pressing on the latches and pulling up.

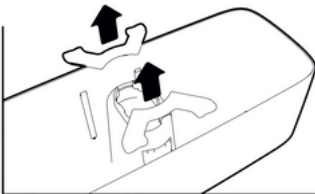

### STEP 4

Remove the water tank supports from the water tank.

## 8- How to Clean?

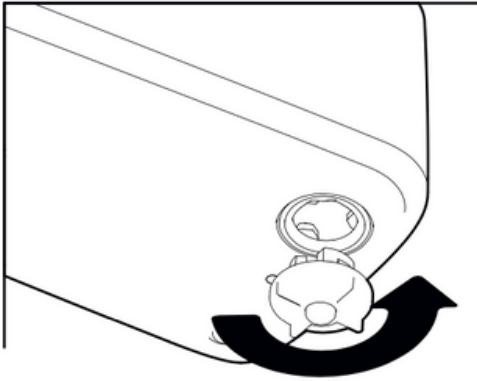

Remove the drain plug by turning in the arrow direction.

Make sure to remove the drain plug only when the water tank is on the sink.

Once you have drained and cleaned your water tank, check the gasket is still in its place in between the water tank and the drain plug.

Remember to re-lock the drain plug in its place tightly. You should double-check that it is tightly closed.

### IMPORTANT



- Lift the lid of the water pump module and remove the filter sponges, wash them with warm water until no residue remains.
- Wash the water tank, seedpod baskets, seedpod tray, germination domes, and drain plug with warm water and dish soap using a soft sponge, and rinse with plenty of water.
- Never wash any parts of Vahaa Smart Garden in the dishwasher!
- When all parts are completely dry, put everything back in the order they were removed.

# 9- Troubleshooting

If you have an issue, check which warning indicator matches what your device is showing.

Follow the steps detailed below to fix the issue. If you can not solve the issue, you can reach out to us for more information through [support@vahaa.co](mailto:support@vahaa.co)

Warning Indicator	Meaning
Steady Red Light	Smart Garden is in Standby Mode.
Steady White Light	Wi-Fi connection is established.
Slow Blinking White Light	The new software installation has started.
Steady Green Light	Smart Garden is on but no Wi-Fi connection.
Consecutive Flashing Mode Button Lights	Bluetooth connection started, Wi-Fi connection setup is in progress.
Mode Button and Indicator Lights Flashing Simultaneously	System reset

# 9- Troubleshooting

Warning Indicator	Meaning	Action
Slow Flashing Ice Blue Light	Downloading new software.	After the software download is completed, complete the installation by pairing your Smart Garden with the Mobile App.
Fast Flashing Yellow Light	Ambient temperature value is above suitable conditions.	Lower the ambient temperature or move your Smart Garden to another location with lower temperature.
Fast Flashing Blue Light	Ambient humidity value is above the suitable conditions.	Lower the ambient humidity or move your Smart Garden to another location with lower humidity.
Slow Blinking Yellow Light	Ambient temperature value is under the suitable conditions.	Increase the ambient temperature or move your Smart Garden to another location with higher temperature.
Slow Blinking Blue Light	Ambient humidity value is under the suitable conditions.	Increase the ambient humidity or move your Smart Garden to another location with higher humidity.
Slow Blinking Green Light	WiFi connection setup is in progress.	Please check your internet connection or place your Smart Garden closer to your modem if light does not change to steady white. For more, please check FAQ via <a href="http://vahaa.co">vahaa.co</a>

## Product Life: 5 Years

### Technical Specifications

Smart Garden Input: 12VDC 3A

Adapter Input: 100-240 VAC 50/60 Hz

Adapter Output: 12VDC 3A

### HANDLING AND SHIPPING

- Your device should be kept in its original box to prevent from damage during handling and shipping.
- Keep the product in its normal position during handling.
- Do not drop your device during shipping and protect against impacts.
- Failures and damages during shipping after the delivery of the product to the customer are not covered by the warranty.

**The product is in compliance with the WEEE Directives.**

#### WEEE

This product contains recyclable materials that compliance with the WEEE directives. Do not dispose this product as unsorted municipal waste. Please contact your local municipality for the nearest collection point.



**Manufacturer:**

**Vahaa Dikey Tarım Çözümleri ve Teknoloji A.Ş.**

Maslak Mah. AOS 55. Sok. 42 Maslak A Blok Sitesi

No:2 İç Kapı No:9 Sarıyer/İstanbul

Türkiye

[www.vahaa.co](http://www.vahaa.co)

# WARRANTY

- 1- The warranty period is 2 years and starts from the delivery date of the product.
- 2- The entire product, including all parts, is covered under warranty.
- 3- In case of a defective product, the consumer has the following rights: The right to have the product repaired or replaced free of charge or The right to receive a proportional price reduction or The right to cancel the contract.
- 4- The consumer can choose between free repair or replacement of the product with a defect-free one for making it suitable. If repair or replacement is impossible or incurs costs disproportionate to the seller, the seller can refuse to make the product suitable. The consumer may prefer to use the free repair right against the manufacturer or importer. The seller, manufacturer, and importer are jointly and severally responsible for the exercise of this right by the consumer. Repairs and replacements are made free of charge within a reasonable period and without significantly affecting the consumer since the unsuitability is notified to the seller.
- 5- In the following cases:
  1. A new defect arising from a product repaired under warranty within the warranty period or
  2. The maximum period required for repair or
  3. The impossibility of repairing determined by the authorized service, dealer, manufacturer, or importer's report, the consumer has the right to request a refund of the product's price, a reduction in the defective amount, or, if possible, replacement with a defect-free product. The seller must comply with the consumer's request. Otherwise, the seller, manufacturer, and importer will be held jointly and severally liable.
- 6- Failures resulting from the use of the product in a way that is not in compliance with the usage manual are not covered by the warranty.



Smart Garden  
VSG001-B / VSG001-P / VSG001-S

**Manufacturer:** Vahaa Dikey Tarım Çözümleri ve Teknoloji A.Ş.

**Address:** Maslak Mah. AOS 55. Sok. 42 Maslak A Blok Sitesi No:2  
İç Kapı No:9 Sarıyer/İstanbul/Türkiye

**E-mail:** support@vahaa.co

**Brand Name:** Vahaa

**Model Name:** Smart Garden

**Model Number:** VSG001-B / VSG001-P / VSG001-S

**Serial Number:**

